

REGISTERED ARCHITECT: TONY LEUNG NSW 7133

---

# SOLAR STUDY

---

**SITE 1 : 23-35 ATCHISON ST, ST LEONARDS**

# PREAMBLE

Aplus Design Group have been engaged by land owners of 23- 35 Atchison St, St Leonards to prepare the solar study on neighbour building surrounding Site 1.

The information provides a comparison against the proposed building with the approved planning proposal and the St leonards planning 2036 `s envelopes, and discusses how the current proposal has better or less impact on surrounding.



**PART 1**

**COMPARISON AGAINST**

**APPROVED PLANNING PROPOSAL**



# STUDY SITE LOCATIONS

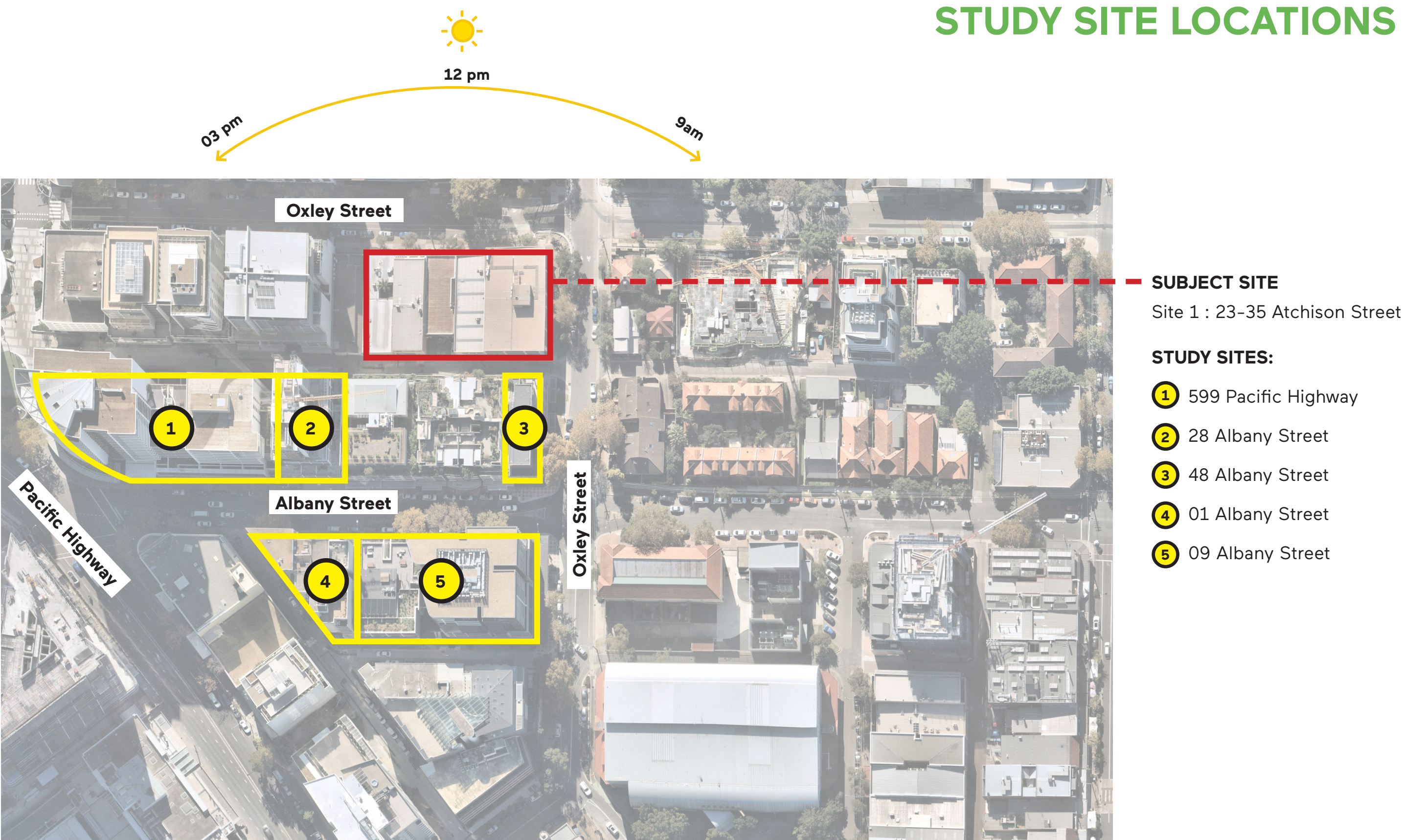



# SOLAR STUDIES

WINTER SOLSTICE - JUNE 21<sup>ST</sup>

## APPROVED PLANNING PROPOSAL

Images extracted from Approved St Leonards - Planning Proposal - Revision AB



9AM



12 PM



03 PM

## PROPOSED DEVELOPMENT

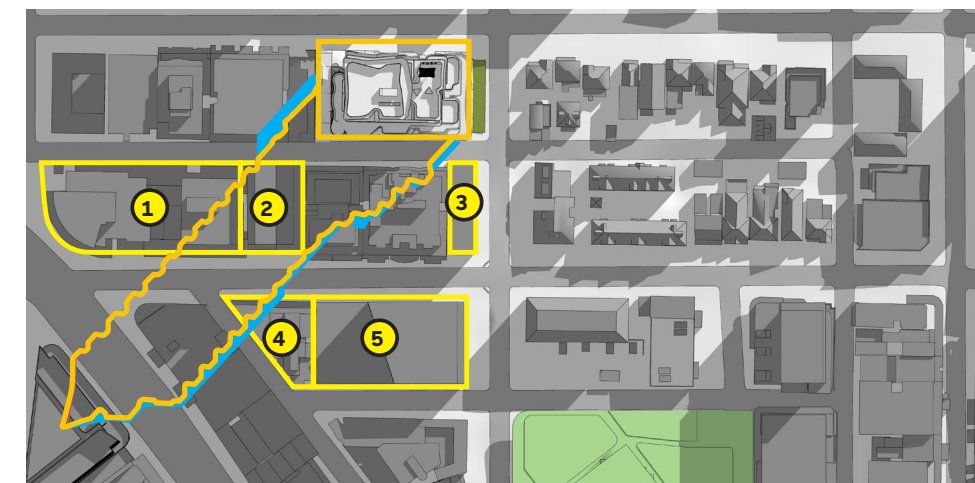

9AM



12 PM



03 PM

### STUDY SITES

- ① 599 Pacific Highway
- ② 28 Albany Street
- ③ 48 Albany Street
- ④ 01 Albany Street
- ⑤ 09 Albany Street

### LEGEND

- APPROVED PLANNING ENVELOPE SHADOW OUTLINE
- PROPOSED DA ENVELOPE SHADOW OUTLINE
- ADDITIONAL SHADOW FROM APPROVED PLANNING PROPOSAL ENVELOPE
- REDUCED SHADOW FROM APPROVED PLANNING ENVELOPE



# SOLAR STUDIES

EQUINOX - MARCH 21<sup>ST</sup>

## APPROVED PLANNING PROPOSAL

Images extracted from Approved St Leonards - Planning Proposal - Revision AB



9AM



12 PM



03 PM

\*Images extracted from Approved St Leonards - Planning Proposal - Site one, page 273

## PROPOSED DEVELOPMENT

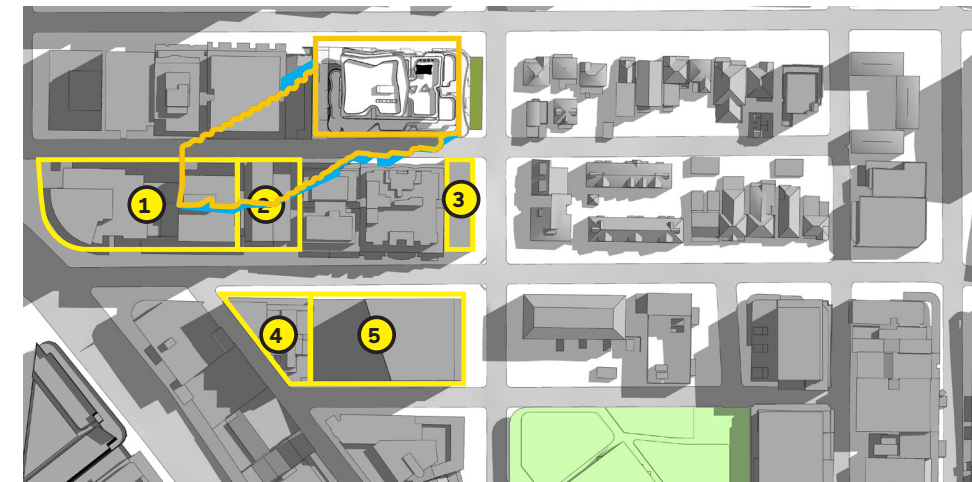

9AM

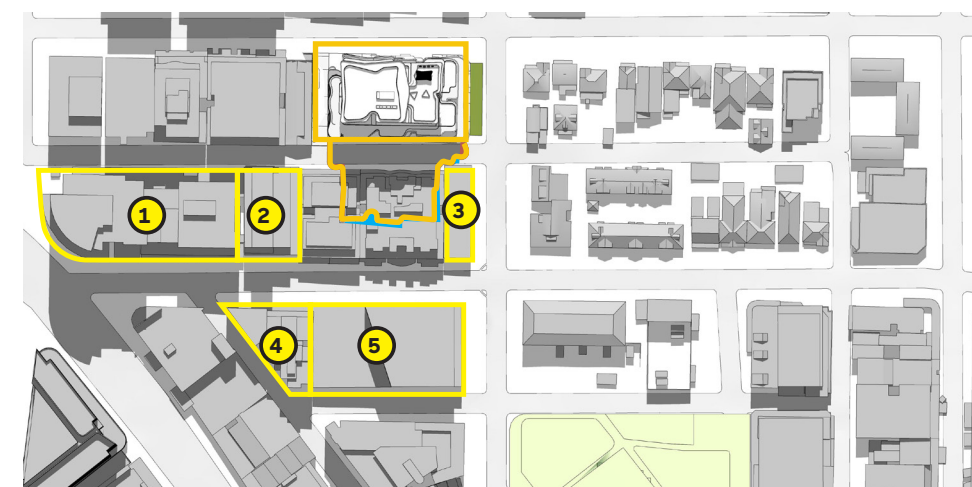

12 PM

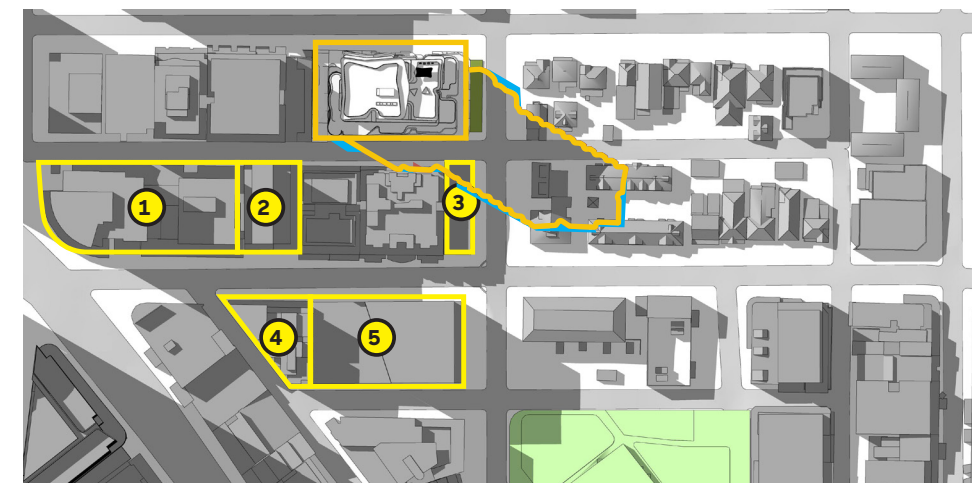

03 PM

### STUDY SITES

- ① 599 Pacific Highway
- ② 28 Albany Street
- ③ 48 Albany Street
- ④ 01 Albany Street
- ⑤ 09 Albany Street

### LEGEND

- APPROVED PLANNING ENVELOPE SHADOW OUTLINE
- PROPOSED DA ENVELOPE SHADOW OUTLINE
- ADDITIONAL SHADOW FROM APPROVED PLANNING PROPOSAL ENVELOPE
- REDUCED SHADOW FROM APPROVED PLANNING ENVELOPE



# SOLAR STUDIES

## APPROVED PLANNING PROPOSAL

Images extracted from Approved St Leonards - Planning Proposal - Revision AB



9AM

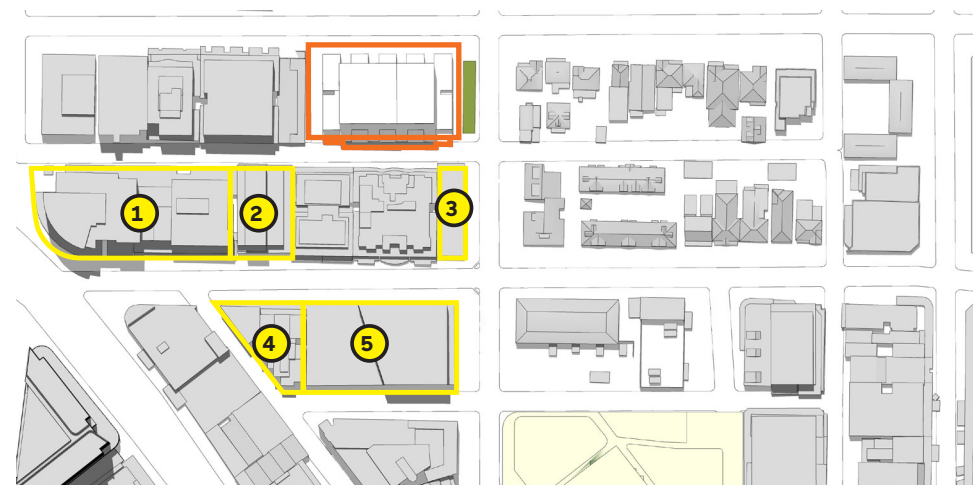

12 PM

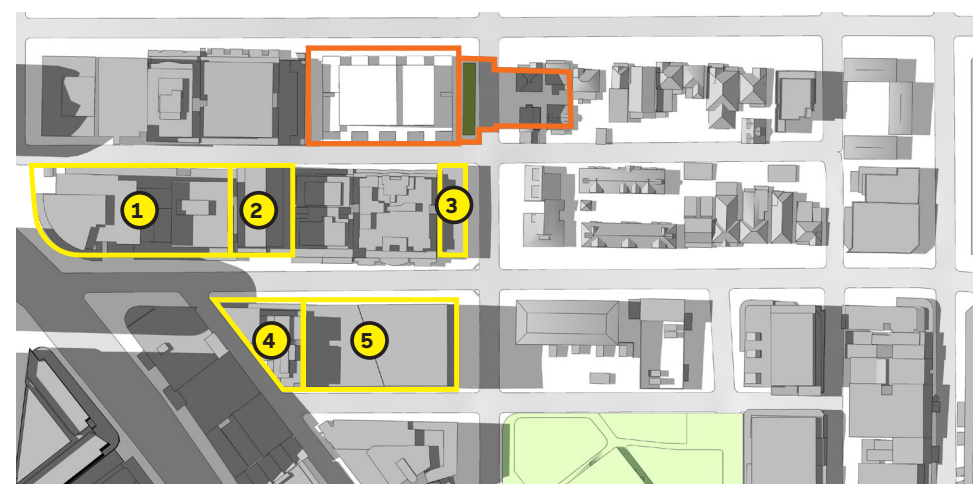

03 PM

## PROPOSED DEVELOPMENT

SUMMER SOLSTICE - DECEMBER 21<sup>ST</sup>

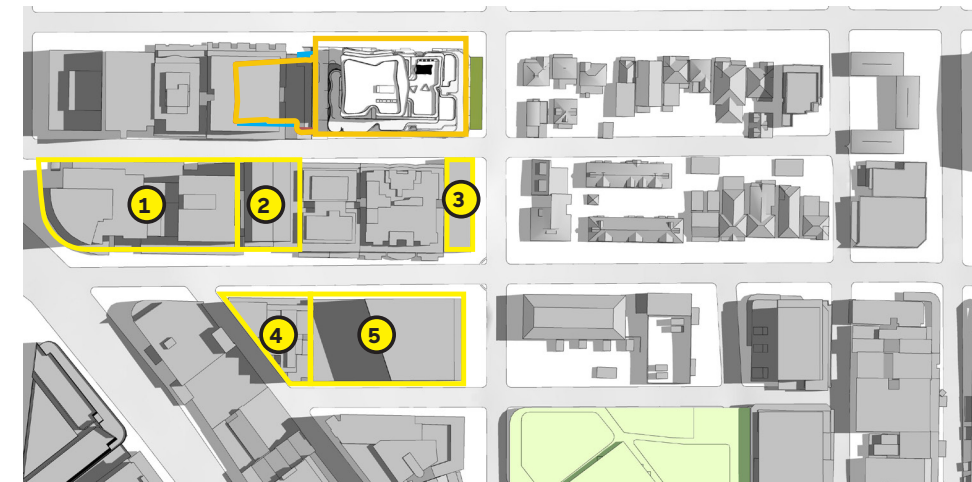

9AM

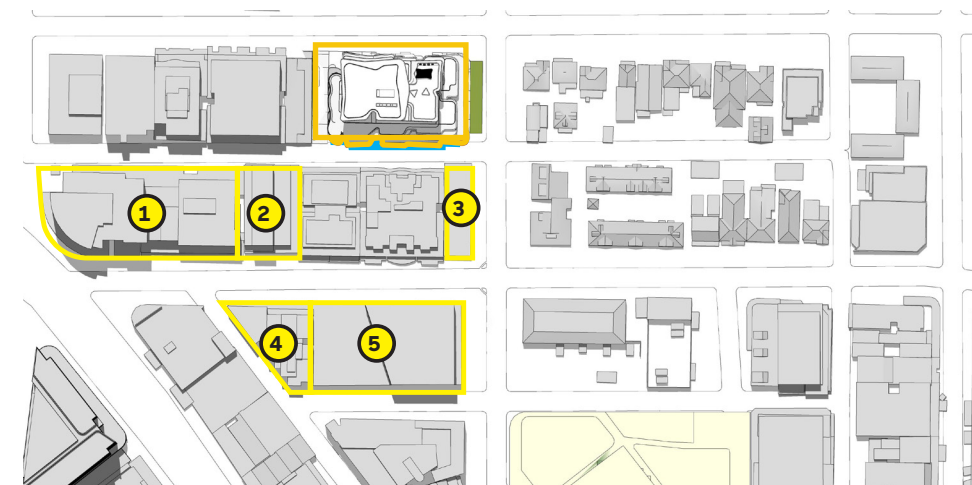

12 PM



03 PM

### STUDY SITES

- ① 599 Pacific Highway
- ② 28 Albany Street
- ③ 48 Albany Street
- ④ 01 Albany Street
- ⑤ 09 Albany Street

### LEGEND

- APPROVED PLANNING ENVELOPE SHADOW OUTLINE
- PROPOSED DA ENVELOPE SHADOW OUTLINE
- ADDITIONAL SHADOW FROM APPROVED PLANNING PROPOSAL ENVELOPE
- REDUCED SHADOW FROM APPROVED PLANNING ENVELOPE

**PART 2**

**COMPARISON AGAINST**

**ST LEONARDS & CROWS NEST**

**2036 PLANNING**



# SOLAR ANALYSIS

21ST JUNE - 2:00 PM

**SITE 1 PLANNING PROPOSAL (REVISION AB , DATE: 05.07.2018 )  
UNDER CURRENT ST LEONARDS CONDITION**

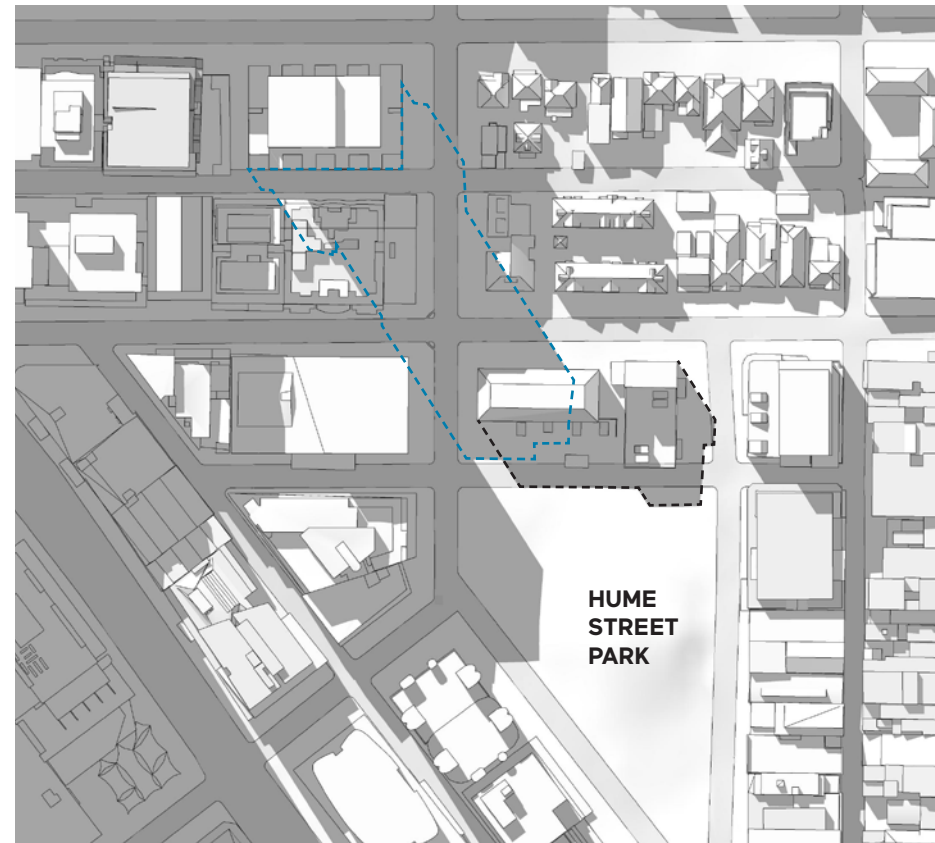

**SITE 1 PLANNING PROPOSAL (REVISION AB , DATE: 05.07.2018 )  
UNDER ST LEONARDS AND CROWS NEST 2036 PLAN  
(SECTION 9.1 MINISTERIAL DIRECTION APPROVED ON 31ST AUGUST 2020)**

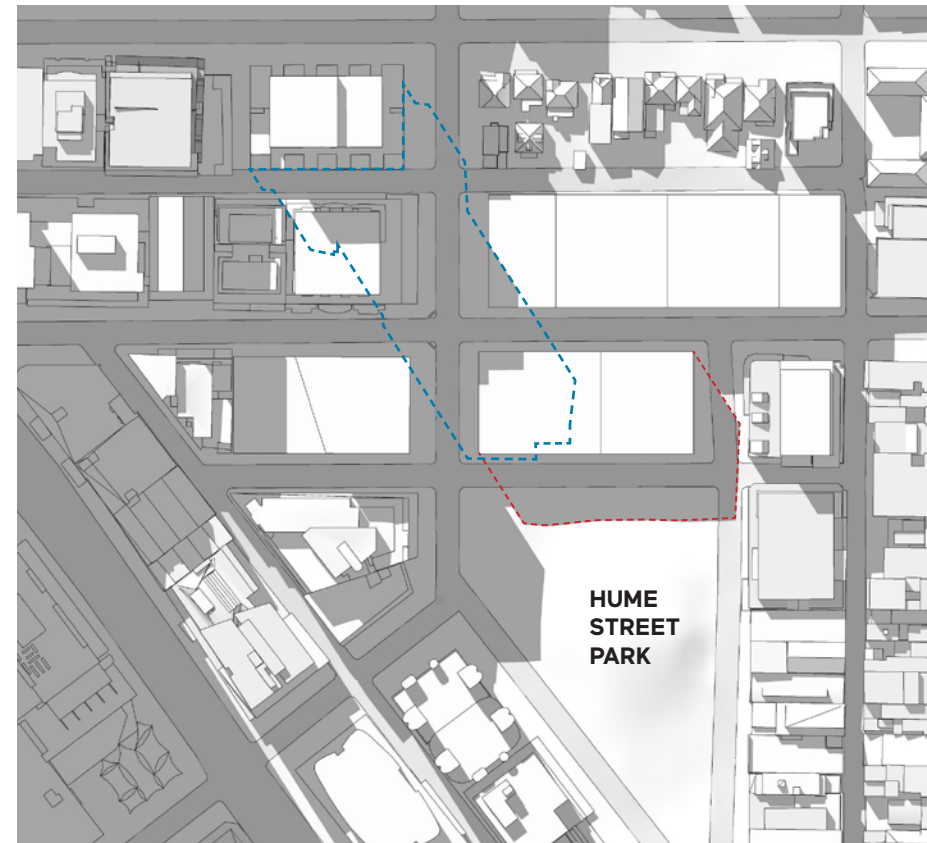

**PROPOSED DA ENVELOPE  
UNDER ST LEONARDS AND CROWS NEST 2036 PLAN  
(SECTION 9.1 MINISTERIAL DIRECTION APPROVED ON 31ST AUGUST 2020)**

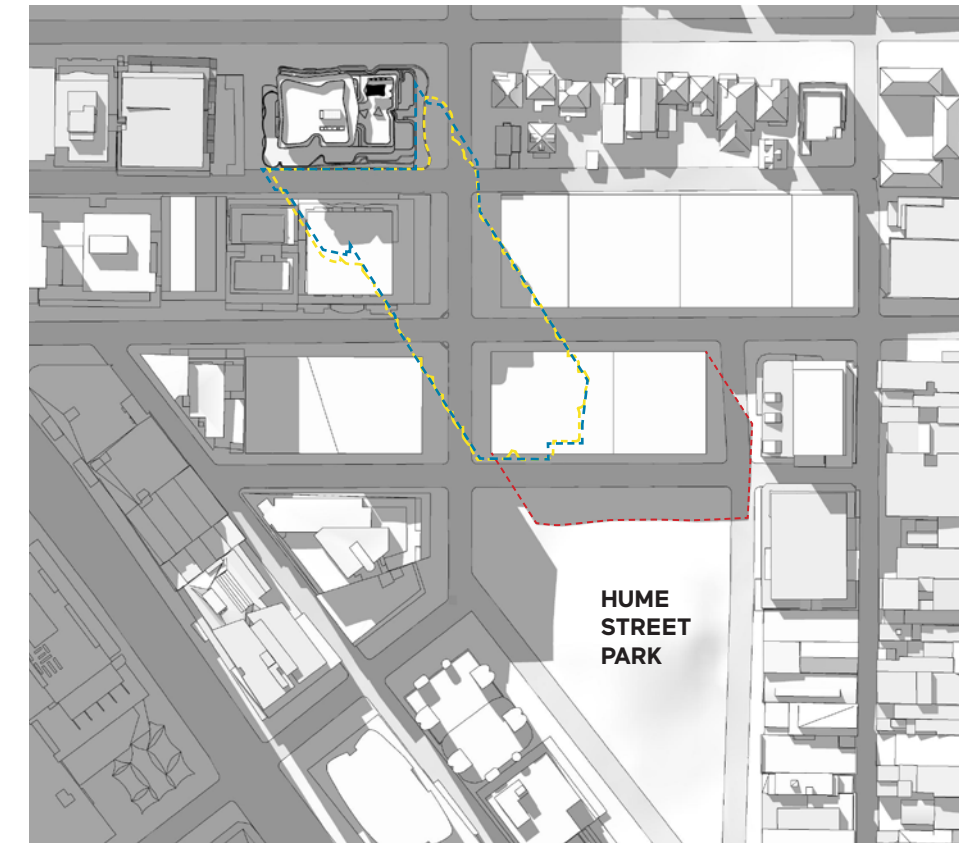

## CONCLUSION

The proposed DA envelope shadow is similar to the approved Site 1 Planning Proposal (Rev AB). The proposed DA envelope shadow sits completely within the permissible envelope for 23-27 Pole Ln (under NSLEP and SLCN 2036 plan) and does not overshadow the Hume St Park.

## LEGEND

- PROPOSED ENVELOPE SHADOW OUTLINE
- APPROVED PLANNING PROPOSAL ENVELOPE SHADOW OUTLINE
- NO.23-27 ALBANY ST SHADOW OUTLINE
- FUTURE SL & CN 2036 PLANNING ENVELOPE SHADOW OUTLINE

# SOLAR ANALYSIS

21ST JUNE - 2:15 PM

SITE 1 PLANNING PROPOSAL (REVISION AB , DATE: 05.07.2018 )  
UNDER CURRENT ST LEONARDS CONDITION

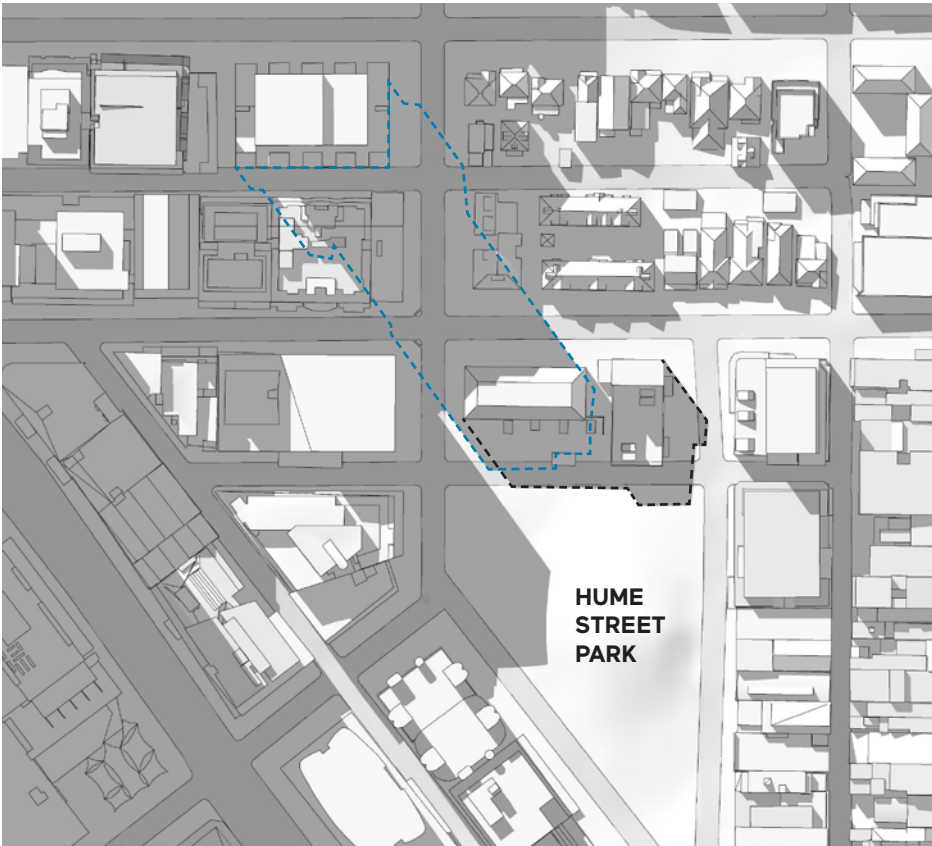

SITE 1 PLANNING PROPOSAL (REVISION AB , DATE: 05.07.2018 )  
UNDER ST LEONARDS AND CROWS NEST 2036 PLAN  
(SECTION 9.1 MINISTERIAL DIRECTION APPROVED ON 31ST AUGUST 2020)

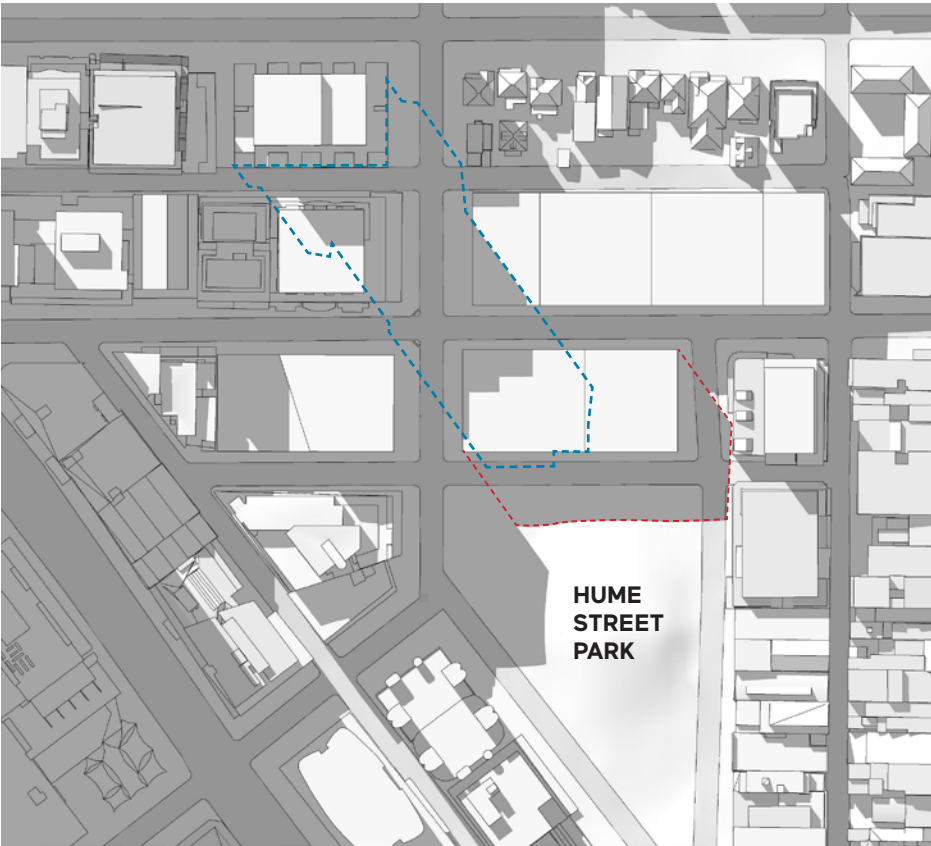

PROPOSED DA ENVELOPE  
UNDER ST LEONARDS AND CROWS NEST 2036 PLAN  
(SECTION 9.1 MINISTERIAL DIRECTION APPROVED ON 31ST AUGUST 2020)

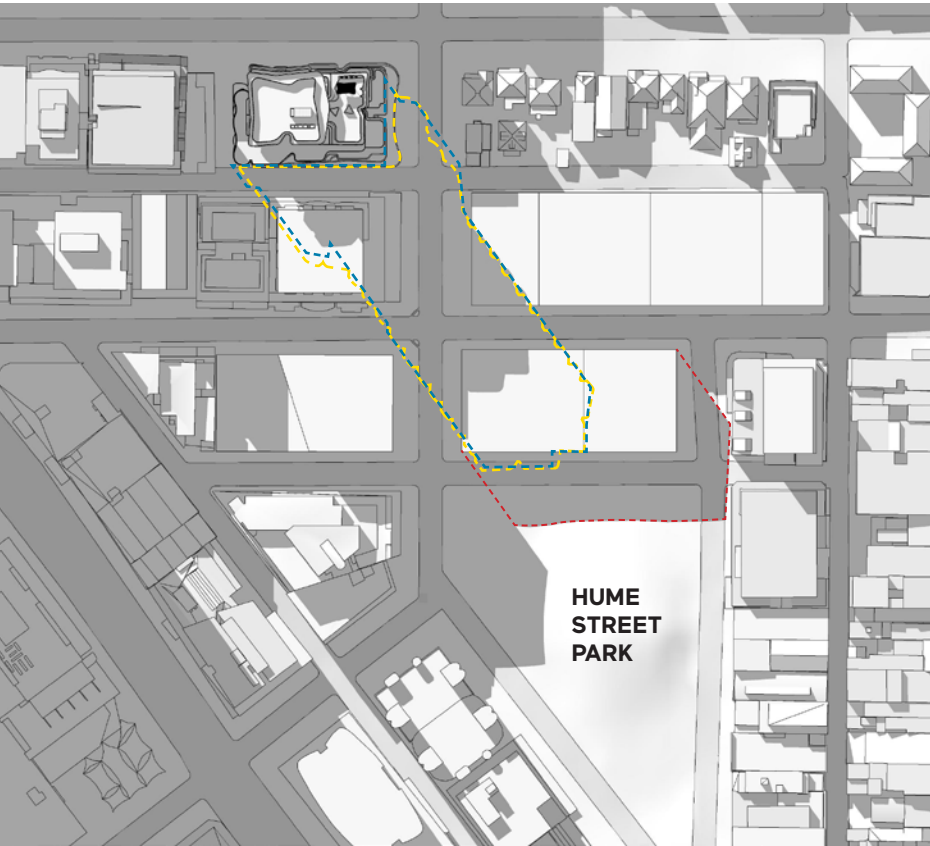

## CONCLUSION

The proposed DA envelope shadow is similar to the approved Site 1 Planning Proposal (Rev AB). The proposed DA envelope shadow sits completely within the permissible envelope for 23-27 Pole Ln (under NSLEP and SLCN 2036 plan) and does not overshadow the Hume St Park.

## LEGEND

- PROPOSED ENVELOPE SHADOW OUTLINE
- APPROVED PLANNING PROPOSAL ENVELOPE SHADOW OUTLINE
- NO.23-27 ALBANY ST SHADOW OUTLINE
- FUTURE SL & CN 2036 PLANNING ENVELOPE SHADOW OUTLINE



# SOLAR ANALYSIS

21ST JUNE - 2:30 PM

SITE 1 PLANNING PROPOSAL (REVISION AB , DATE: 05.07.2018 )  
UNDER CURRENT ST LEONARDS CONDITION

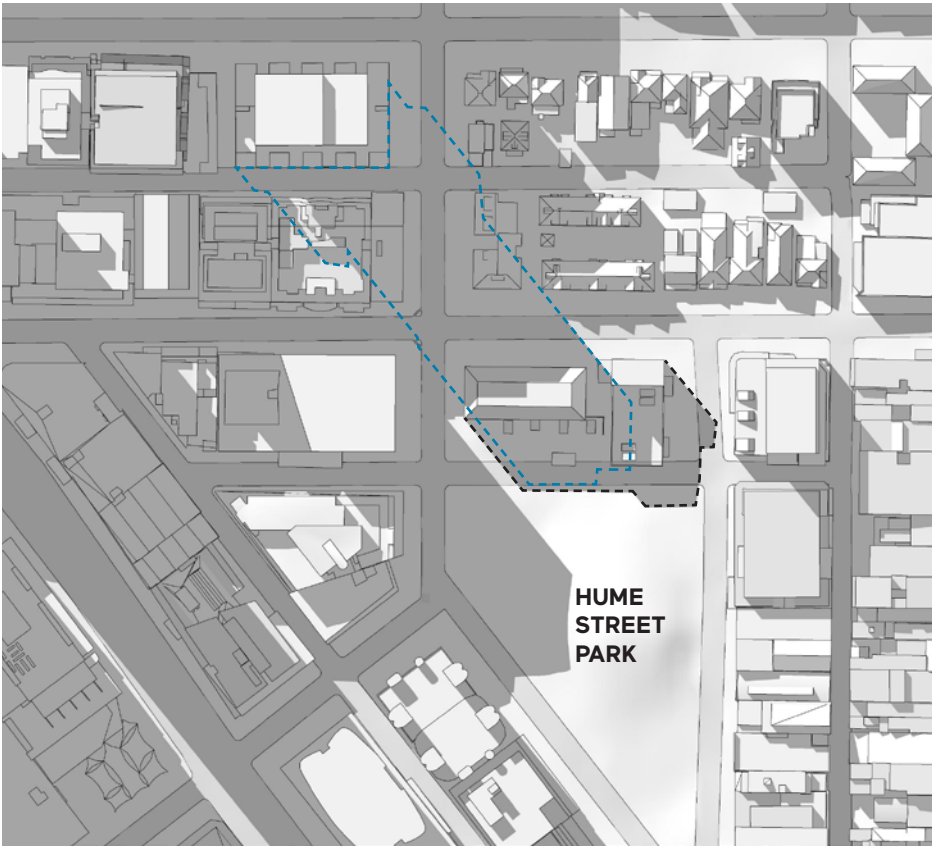

SITE 1 PLANNING PROPOSAL (REVISION AB , DATE: 05.07.2018 )  
UNDER ST LEONARDS AND CROWS NEST 2036 PLAN  
(SECTION 9.1 MINISTERIAL DIRECTION APPROVED ON 31ST AUGUST 2020)

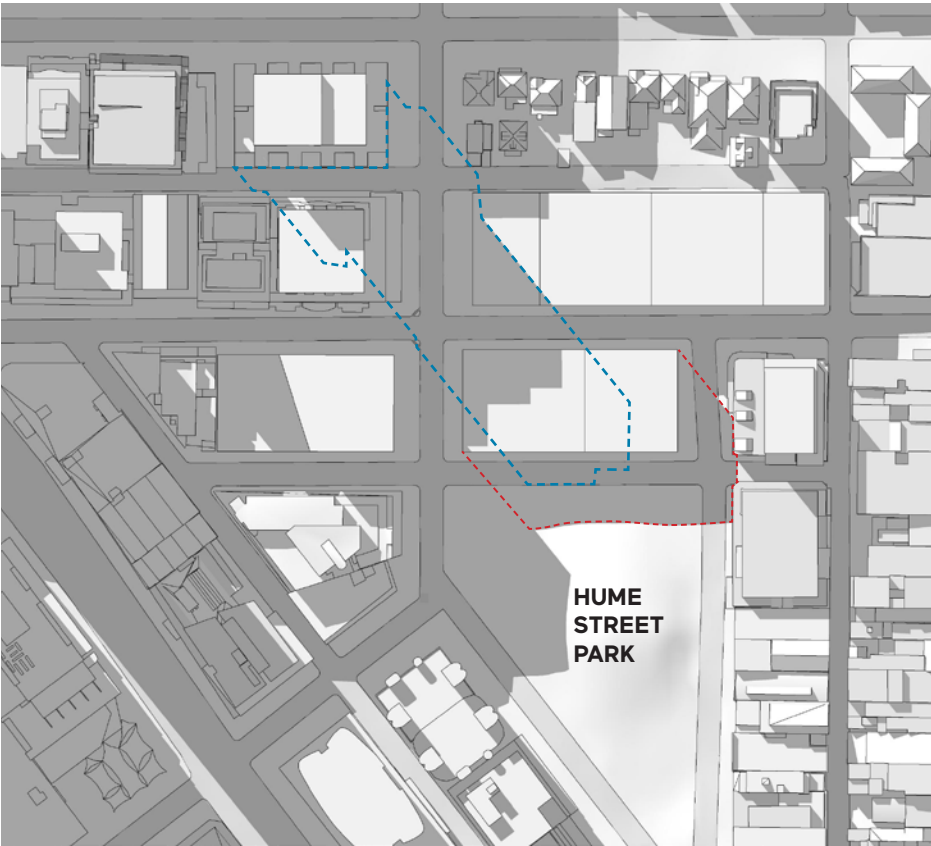

PROPOSED DA ENVELOPE  
UNDER ST LEONARDS AND CROWS NEST 2036 PLAN  
(SECTION 9.1 MINISTERIAL DIRECTION APPROVED ON 31ST AUGUST 2020)

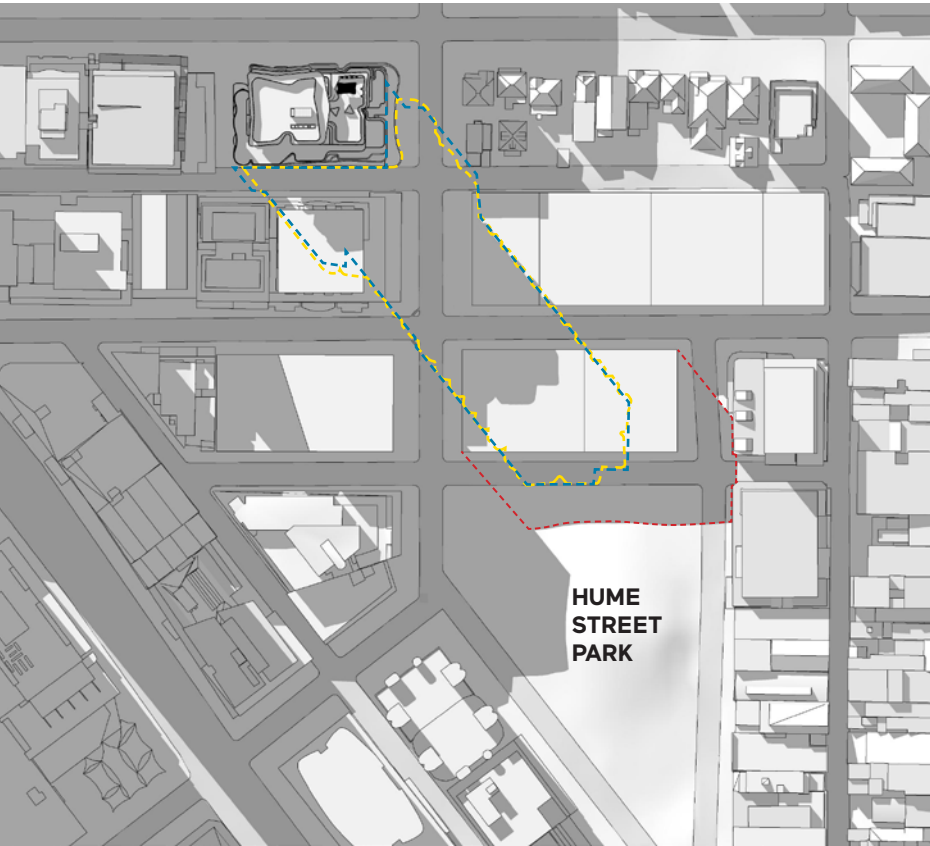

## CONCLUSION

The proposed DA envelope shadow is similar to the approved Site 1 Planning Proposal (Rev AB). The proposed DA envelope shadow sits completely within the permissible envelope for 23-27 Pole Ln (under NSLEP and SLCN 2036 plan) and does not overshadow the Hume St Park.

## LEGEND

- PROPOSED ENVELOPE SHADOW OUTLINE
- APPROVED PLANNING PROPOSAL ENVELOPE SHADOW OUTLINE
- NO.23-27 ALBANY ST SHADOW OUTLINE
- FUTURE SL & CN 2036 PLANNING ENVELOPE SHADOW OUTLINE





# SOLAR ANALYSIS

21ST JUNE - 2:45 PM

**SITE 1 PLANNING PROPOSAL (REVISION AB , DATE: 05.07.2018 )  
UNDER CURRENT ST LEONARDS CONDITION**

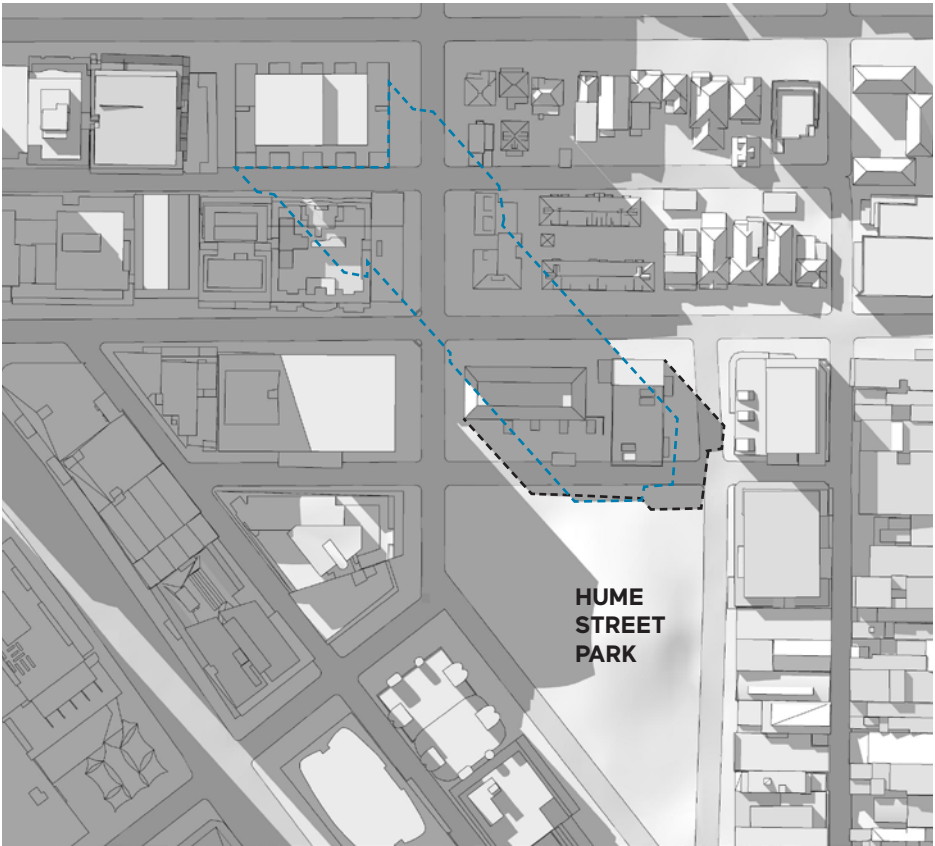

**SITE 1 PLANNING PROPOSAL (REVISION AB , DATE: 05.07.2018 )  
UNDER ST LEONARDS AND CROWS NEST 2036 PLAN  
(SECTION 9.1 MINISTERIAL DIRECTION APPROVED ON 31ST AUGUST 2020)**

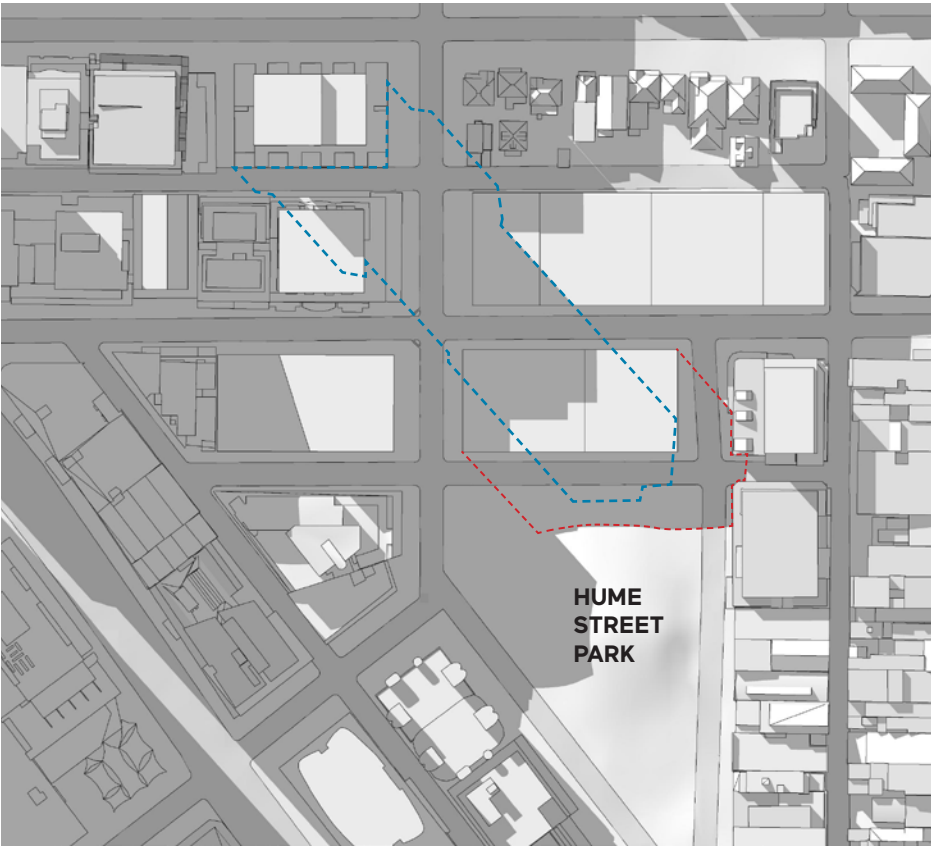

**PROPOSED DA ENVELOPE  
UNDER ST LEONARDS AND CROWS NEST 2036 PLAN  
(SECTION 9.1 MINISTERIAL DIRECTION APPROVED ON 31ST AUGUST 2020)**



## CONCLUSION

The proposed DA envelope shadow is similar to the approved Site 1 Planning Proposal (Rev AB). The proposed DA envelope shadow sits completely within the permissible envelope for 23-27 Pole Ln (under NSLEP and SLCN 2036 plan) and does not overshadow the Hume St Park.

## LEGEND

- PROPOSED ENVELOPE SHADOW OUTLINE
- APPROVED PLANNING PROPOSAL ENVELOPE SHADOW OUTLINE
- NO.23-27 ALBANY ST SHADOW OUTLINE
- FUTURE SL & CN 2036 PLANNING ENVELOPE SHADOW OUTLINE



# SOLAR ANALYSIS

21ST JUNE - 3:00 PM

**SITE 1 PLANNING PROPOSAL (REVISION AB , DATE: 05.07.2018 )  
UNDER CURRENT ST LEONARDS CONDITION**

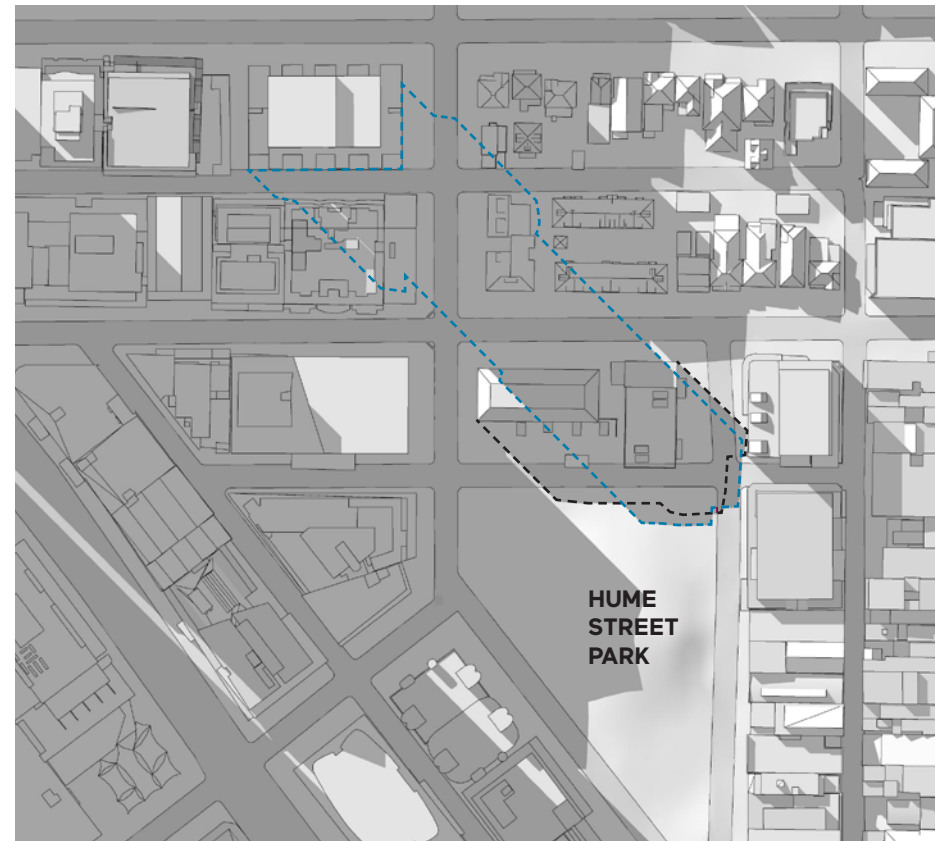

**SITE 1 PLANNING PROPOSAL (REVISION AB , DATE: 05.07.2018 )  
UNDER ST LEONARDS AND CROWS NEST 2036 PLAN**  
(SECTION 9.1 MINISTERIAL DIRECTION APPROVED ON 31ST AUGUST 2020)

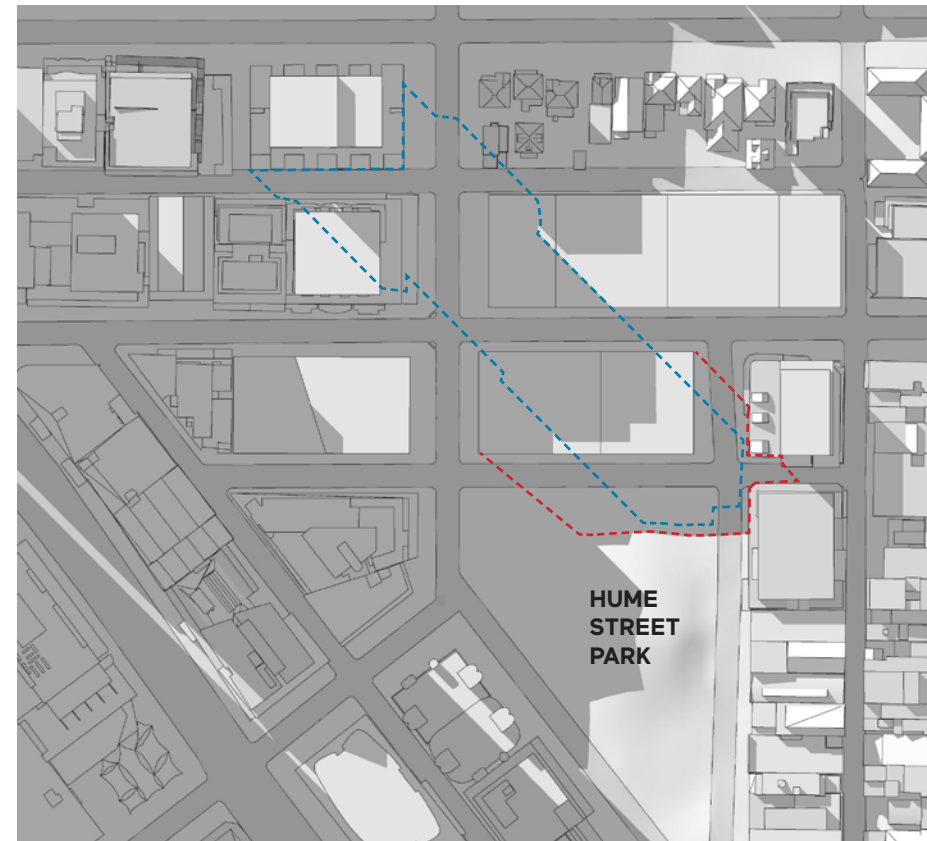

**PROPOSED DA ENVELOPE  
UNDER ST LEONARDS AND CROWS NEST 2036 PLAN**  
(SECTION 9.1 MINISTERIAL DIRECTION APPROVED ON 31ST AUGUST 2020)

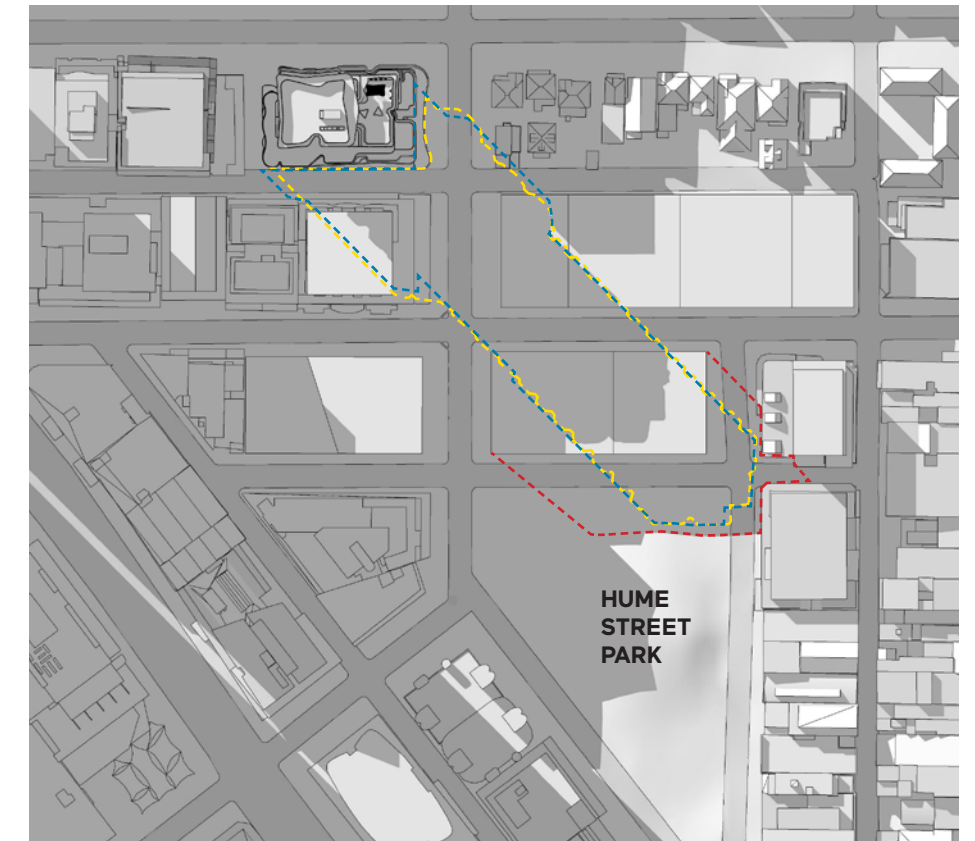

## CONCLUSION

The proposed DA envelope shadow is similar to the approved Site 1 Planning Proposal (Rev AB). The proposed DA envelope shadow sits completely within the permissible envelope for 23-27 Pole Ln (under NSLEP and SLCN 2036 plan) and does not overshadow the Hume St Park.

## LEGEND

- PROPOSED ENVELOPE SHADOW OUTLINE
- APPROVED PLANNING PROPOSAL ENVELOPE SHADOW OUTLINE
- NO.23-27 ALBANY ST SHADOW OUTLINE
- FUTURE SL & CN 2036 PLANNING ENVELOPE SHADOW OUTLINE

#### DISCLAIMER

The scheme contained within this document have been prepared by a+ Design Group solely for the purpose of providing information about potential schemes.

The materials should not be considered to be error free or to include all relevant information.

Nothing in this document in any way constitutes advice or a representation by a+ Design Group nor does the transmission or sending of these materials create any contractual relationship.

Neither a+ Design Group nor any of its officers, employees, agents or contractors, will be liable for any direct or indirect loss or damage you may suffer or incur arising directly or indirectly from the use of any materials from this document.

A+ Design Group retains copyright and all present and future moral rights in all intellectual property in all the materials authored by it and in any works executed from these drawings and documents.



NOMINATED ARCHITECT: TONY **LEUNG**  
**APLUS DESIGN GROUP**

---

A: Level 3, 9 BARRACK ST, SYDNEY, NSW 2000  
Ph: 1300 377 789 | W: [www.aplusedg.com.au](http://www.aplusedg.com.au)